

THIS MAP WAS PREPARED FOR
ASSESSMENT PURPOSE ONLY

T.35S. R.12W. W.M.
CURRY COUNTY

See Map 34 12 1"=2000'

See T.L. 2600 of 300
1. S. 53° 00' E. 167.64'
2. S. 14° 00' E. 134.44'
3. S. 19° 30' E. 174.86'
4. S. 19° 00' E. 37.00'
5. EAST
TO K. LINE LOT 4

See T.L. 280
Dist. 532° 00' W. 12.96 ft.
FROM E. 1/4 COR. SEC. 17, T. 34 S., R. 12 W., W.M.
1. S. 88° 00' W. 259.96'
2. N. 89° 45' W. 129.75'
3. S. 50° 15' E. 284.38'
4. N. 89° 45' W. 194.00'
5. N. 60° 30' W. 226.38'
6. N. 89° 45' W. 289.75'
7. N. 81° 22' E. 255.50'
8. S. 86° 00' E. 652.74'
TO P.O.B.

See T.L. 2400
Dist. 282° 00' Fr. S. 1/4 Sec. 20
W. of N.E. Cor. Sec. 20
1. N. 4. S. 43° 00' E. 190.3'
2. N. S. 53° 20' E. 250.0'
To ordinary High Water
right bank of Rogue R.
3. 1/4 SW 1/4 along right
bank 980.0 ft. m/l. to
center of unnamed Cr.
4. th. up said Cr. to pt.
200.0 ft. down stream from
N.E. Cor. to Class. Lease
2-2477
5. N. NELY 1000.0 ft. m/l.
to P.O.B.

See T.L. 2500
Dist. 850.0 ft. N. of 700.0 ft. Cr.
W. of Mouth of Tommy Cr.
1. N. S. 57° 00' E. 44.0'
2. N. S. 30° 20' E. 177.1'
3. N. S. 70° 00' E. 194.3'
4. N. S. 70° 45' E. 195.4'
5. N. S. 70° 30' E. 174.3'
6. N. N. 80° 00' E. 87.4'
7. N. N. 80° 00' E. 152.3'
8. N. N. 77° 20' E. 271.4'
9. N. N. 37° 30' E. 448.2'
to center of creek
10. N. S. 81° 1/2 follow center Cr.
900.0 ft. m/l. to N. Bend of
Rogue River.
11. N. S. 81° 1/2 follow said N.
bank 1600.0 ft. m/l. to P.O.B.

SCALE IN FEET
0 2000 4000

See Map 35 13

CANCELLED NO
1000
1001
600
601
700
700A1
3301 THRU 3700
3900 THRU 4102

SEC. 13
PARCEL 1202
1. 1/4 Sec. 13
2. N. 1/4 Sec. 13
3. S. 1/4 Sec. 13
4. S. 1/4 Sec. 13
5. S. 1/4 Sec. 13
6. S. 1/4 Sec. 13
7. S. 1/4 Sec. 13
8. S. 1/4 Sec. 13
9. S. 1/4 Sec. 13
10. S. 1/4 Sec. 13
11. S. 1/4 Sec. 13
12. S. 1/4 Sec. 13
13. S. 1/4 Sec. 13
14. S. 1/4 Sec. 13
15. S. 1/4 Sec. 13
16. S. 1/4 Sec. 13
17. S. 1/4 Sec. 13
18. S. 1/4 Sec. 13
19. S. 1/4 Sec. 13
20. S. 1/4 Sec. 13
21. S. 1/4 Sec. 13
22. S. 1/4 Sec. 13
23. S. 1/4 Sec. 13
24. S. 1/4 Sec. 13
25. S. 1/4 Sec. 13
26. S. 1/4 Sec. 13
27. S. 1/4 Sec. 13
28. S. 1/4 Sec. 13
29. S. 1/4 Sec. 13
30. S. 1/4 Sec. 13
31. S. 1/4 Sec. 13
32. S. 1/4 Sec. 13
33. S. 1/4 Sec. 13
34. S. 1/4 Sec. 13
35. S. 1/4 Sec. 13
36. S. 1/4 Sec. 13

Revised
6/8/2009, RAA

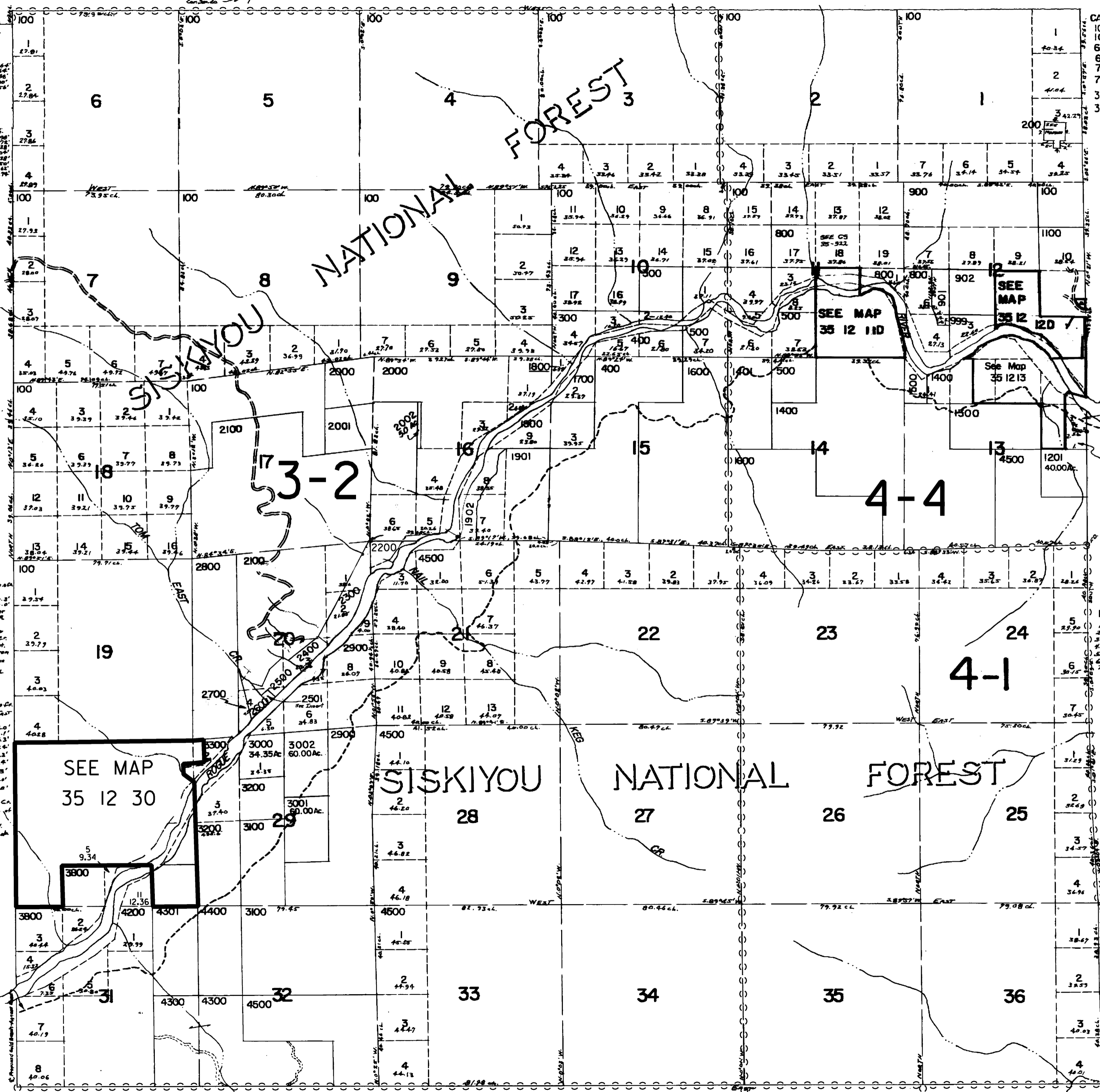

See Map 36 12

THIS MAP WAS PREPARED FOR
ASSESSMENT PURPOSE ONLY

T.35S. R.12W. W.M.
CURRY COUNTY

See Map 34 12 1"=2000'

CANCELLED NO
1000
1001
600
601
700
700A1
3301 THRU 3700
3900 THRU 4102

See T.L. 2400 of 300
1. S. 55° 0' 0" E. 162.64'
2. S. 16° 0' 0" E. 134.64'
3. S. 17° 30' 0" E. 174.86'
4. S. 20° 0' 0" E. 92.00'
5. EAST
TO E. LINE Lot 4

See T.L. 2800
Dist. 5320' to C. 12000'
FROM E. 1/4 COR. SEC. 17, T. 34S., R. 12W., W.M.
1. S. 88° 30' 0" W. 255.98'
2. N. 88° 30' 0" W. 127.99'
3. S. 50° 10' 0" E. 284.38'
4. N. 89° 40' 0" W. 184.00'
5. N. 60° 30' 0" W. 226.38'
6. N. 89° 20' 0" W. 280.70'
7. N. 87° 22' 0" E. 253.50'
8. S. 86° 0' 0" E. 652.70'
To P.O.B.

See T.L. 2400
By 2629.0 ft. S. 1/2 Sec. 20
W. of N.E. Cor. Sec. 20
1. Th. S. 45° 0' 0" E. 190.3'
2. Th. S. 53° 20' 0" E. 230.0'
To ordinary High Water
right bank of Rogue R.
3. Th. SWly along right
bank 980.0 ft. m/l. to
center of unnamed Cr.
4. Th. up said Cr. to pt.
200.0 ft. down stream from
N.E. Cor. to Class. Lease
(2-247)
5. Th. NEly 1000.0 ft. m/l.
to P.O.B.

See T.L. 2500
By 850.0 ft. N. of 7000.0 ft.
W. of Mouth of Tommy Gut
Cr.
1. Th. S. 57° 0' 0" E. 44.0'
2. Th. S. 30° 20' 0" E. 171.1'
3. Th. S. 70° 20' 0" E. 184.3'
4. Th. S. 70° 45' 0" E. 195.4'
5. Th. S. 70° 30' 0" E. 174.3'
6. Th. N. 80° 0' 0" E. 87.4'
7. Th. N. 84° 0' 0" E. 152.3'
8. Th. N. 77° 20' 0" E. 271.4'
9. Th. N. 37° 30' 0" E. 448.2'
to center of creek
10. Th. S. 8ly follow center Cr.
900.0 ft. m/l. to N. Body of
Rogue River.
11. Th. SWly follow said N.
bank 1600.0 ft. m/l. to P.O.B.

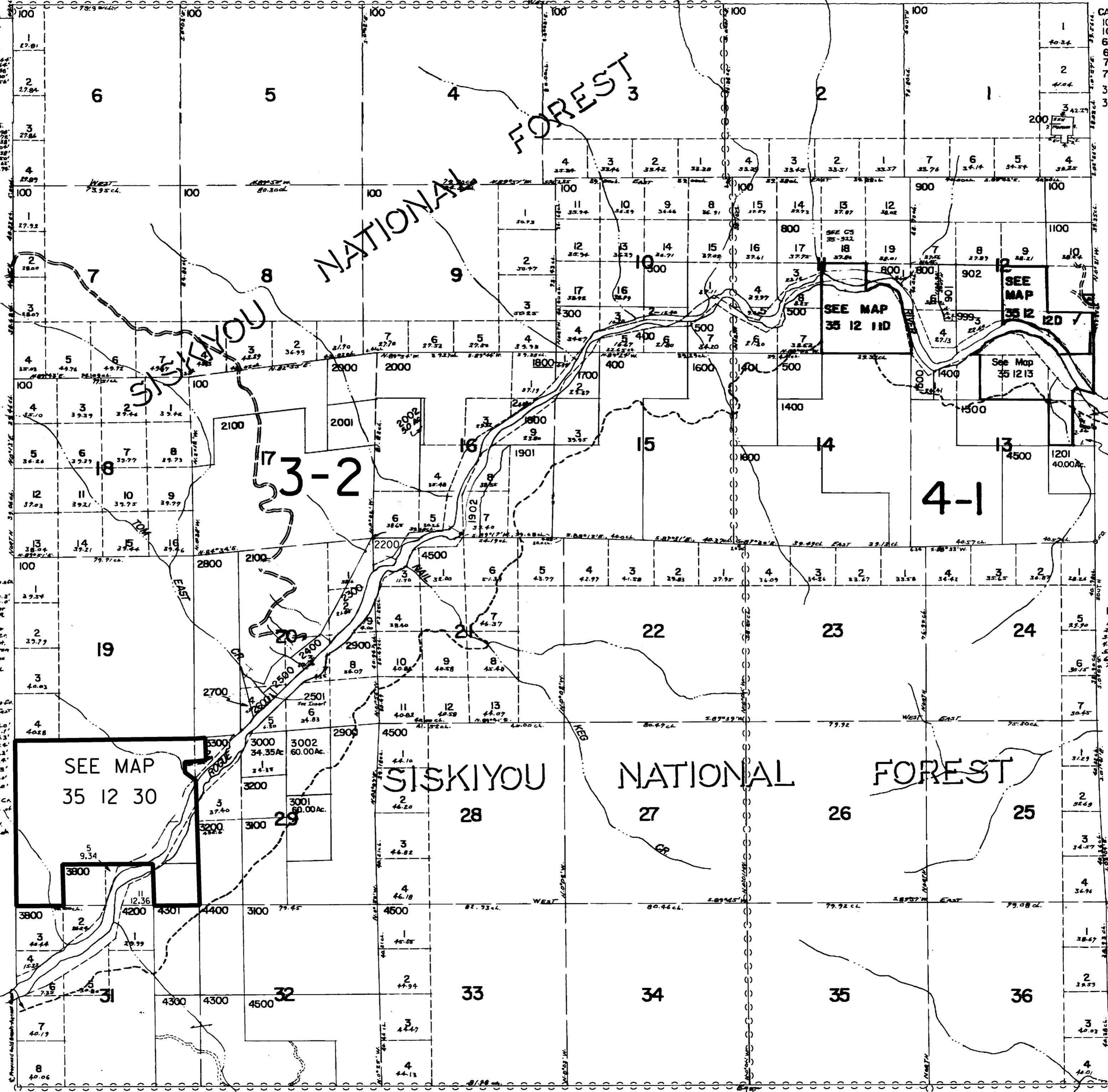

SCALE IN FEET
0 2000 4000

See Map 35 13

SEC. 13
PARCEL 1202
1. 48° 21' W. 400.0'
2. N. 70° 10' W. 107.0'
3. S. 53° 12' W. 350.19'
4. S. 53° 00' W. 128.70'
5. S. 84° 52' E. 300.00'
6. N. 40° 02' E. 161.91'
7. S. 87° 24' E. 178.48'

Revised
10/24/2006, CS

THIS MAP WAS PREPARED FOR
ASSESSMENT PURPOSE ONLY

T.35S. R.12W.W.M.
CURRY COUNTY

1"=2000'
See Map 34 12

CANCELLED NO
1000
1001
600
601
700
700A1
3301 THRU 3700
3900 THRU 4102

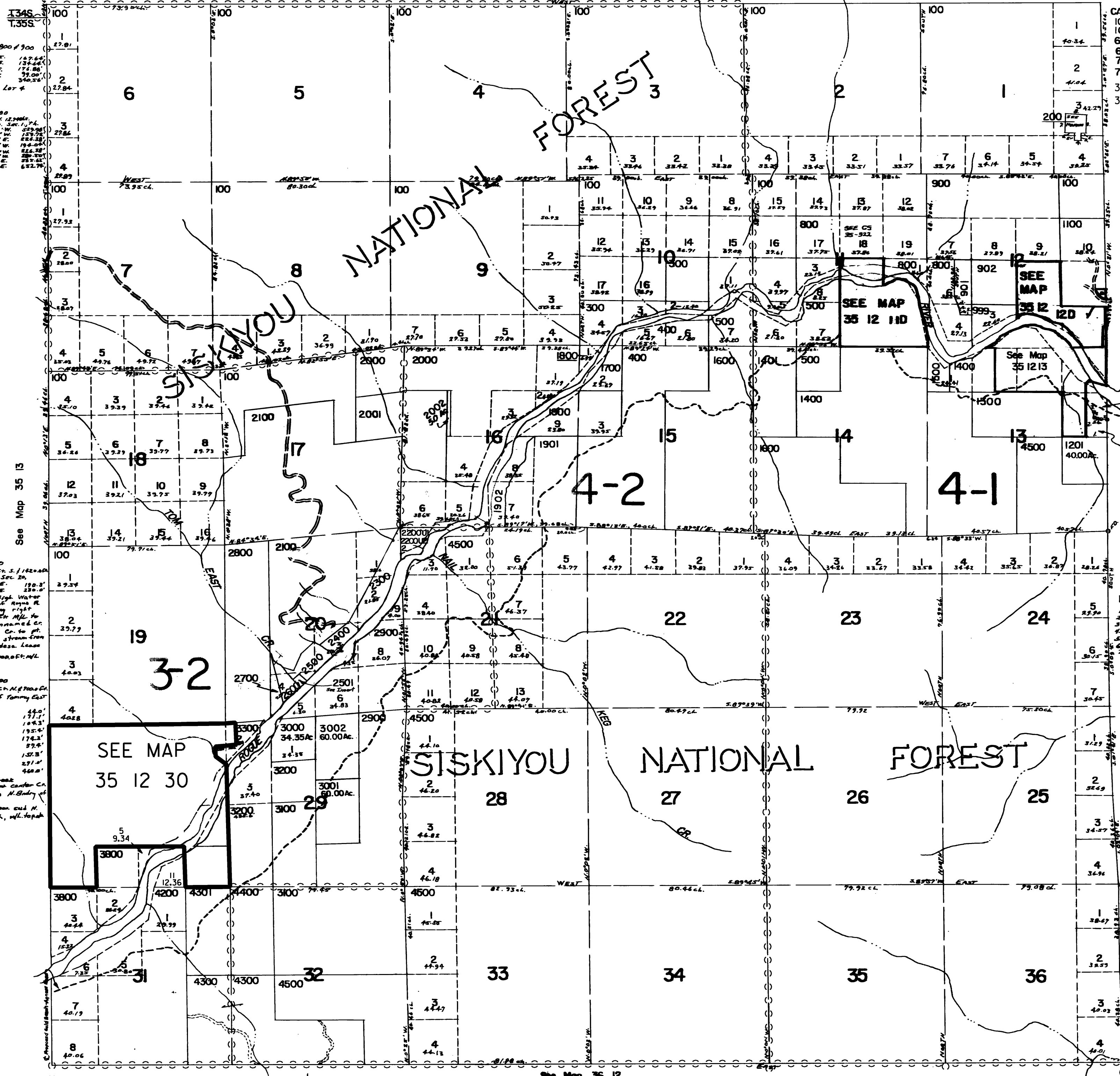

See T. 25.000 # 900
1. S. 32° 0' 0" E. 147.64'
2. S. 14° 0' 0" E. 134.64'
3. S. 14° 0' 0" E. 174.80'
4. S. 12° 0' 0" E. 99.00'
5. East
to N. Line Lot 4

See T.L. 200
Div. S. 32° 0' 0" E. 12.946'
From E. to Cor. Sec. 1, T. 74.
1. N. 88° 0' 0" W. 123.75'
2. S. 30° 14' 0" E. 124.33'
3. N. 89° 0' 0" W. 194.04'
4. N. 0° 0' 0" W. 824.38'
5. N. 89° 0' 0" W. 209.70'
6. N. 87° 0' 0" E. 285.45'
7. S. 86° 0' 0" E. 652.79'
to P.O.B.

See T.L. 2400
Div. 2629.0 Ft. S. 1/1620.0 ft.
W. of N.E. Cor. Sec. 20,
1. N. 5.42° 0' 0" E. 190.2'
2. N. 3.32° 0' 0" E. 230.0'
to ordinary High Water
right bank of Rogue R.
3. N. 5.00° 0' 0" E. 190.2'
bank 900.0 ft. N.W. to
center of unnamed Cr.
4. N. up said Cr. to pt.
200.0 ft. down stream from
N.E. Cor. to (base) Lease
2-2477
5. N. N.E. 1/4 Sec. 20 to P.O.B.

See T.L. 2500
Div. 850.0 ft. N. of 7000.0 ft.
W. of Mouth of Tommy Cr.
1. N. S. 30° 0' 0" E. 44.0'
2. N. S. 30° 0' 0" E. 171.1'
3. N. S. 70° 0' 0" E. 104.3'
4. N. S. 70° 0' 0" E. 192.4'
5. N. S. 70° 0' 0" E. 174.2'
6. N. S. 70° 0' 0" E. 89.9'
7. N. N. 30° 0' 0" E. 152.8'
8. N. N. 70° 0' 0" E. 251.4'
9. N. N. 30° 0' 0" E. 468.0'
to center of creek
10. N. S. 30° 0' 0" E. 900.0 ft. N.W. to N. End of
Rogue River
11. N. S. 30° 0' 0" E. 1600.0 ft. N.W. to top of
bank 1600.0 ft. N.W. top of

SEC. 13
PARCEL 1202
1. 489° 25' 0" 800.0'
2. 10° 0' 0" W. 1000'
3. S. 30° 0' 0" E. 350.19'
4. S. 2° 0' 0" E. 126.78'
5. 59° 0' 0" E. 80.49'
6. 400° 0' 0" E. 161.97'
7. S. 87° 0' 0" E. 798.48'

REVISED
3-19-99, RA